



## M12 Male Conector Panel Mounting 12 Pin A Code Circular Connectors for PCB Mounting

Our Product Introduction

for more products please visit us on [connector-industrial.com](http://connector-industrial.com)

### Basic Information

- Place of Origin: Guangdong, China
- Brand Name: KRONZ
- Certification: CE
- Model Number: F1212M-PM/M16
- Minimum Order Quantity: 50 pieces
- Price: Negotiable
- Packaging Details: Polybag packing
- Delivery Time: 5-8 working days
- Payment Terms: T/T, Western Union, MoneyGram
- Supply Ability: 100000 pieces per month

KRONZ



### Product Specification

- Description: Panel Mount M12 Male Connector
- Series: M12
- Color: Siliver
- Material: Brass,gold-plated
- IP Rate: IP67
- Contact Resistance:  $\leq 5\text{m}\Omega$
- Ambient Temperature: -25~+85
- Connects Termination: PCB Version
- Highlight: circular m12 connector, circular m12 female connector, pcb m12 connector

KRONZ



### More Images



KRONZ



KRONZ



## Product Description

### M12 Male Conector Panel Mounting 12 Pin A Code Circular Connectors for PCB Mounting

#### Product Description

M12 Field Wireable Connector, A Code, 12Pin, Female, Male, Straight, for Cable, Screw-Joint, Unshield, IP67 Waterproof.

M12 Aviation Panel Back Mount Flange Socket Sensor Connector use professional high quality black nylon plastic makes it Insulation and flame retardant. Thread locking mechanism, anti vibration locking design, 12mm thread joint. Waterproof led connector use All-copper nickel-plated metal screw sleeve, pure copper gold-plated contacts, robust and corrosion-resistant, durable, while ensuring the stability and reliability of data and signals.

The Waterproof 12mm Aviation Wire Connector are IP67 Compliant. High elastic rubber ring and clamping nuts provide a perfect waterproof /dust-proof, prevent the network parts from moisture, dirt rain & snow and insects for quality connections.

12mm M12 Metal Chassis Thread Panel Connector Socket widely used in signal electronic connector of aviation, computer, various kinds of instruments and industrial cameras, electric bicycles, factory automation, can be easily connected to proximity switches, photoelectric barriers, flow monitoring devices, sensor devices and ctuator devices and field bus components.

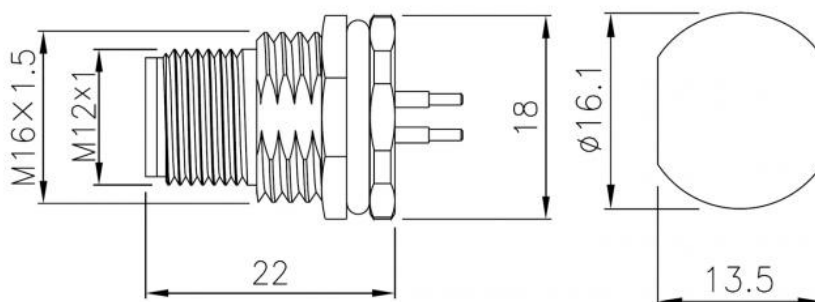

#### Technical Data

Standard	IEC 61076-2-101
Contact nut material	Brass, nickle-plated
Contact surface material	Brass, gold-plated
Contact carrier material	PA, black
Housing material	Brass, nickel-plated
Seal material	FPM/FKM
Insulation resistance	≥100MΩ
Contact resistance	≤5mΩ
Pollution degree	3
Ambient temperature	-25~+85
Mating cycles	>100
Degree of protection	IP67

Pin assignment	Mounting type	Coding	Rated current	Voltage	Cable outlet	Contacts termination	Part No.
	Front mounting	A	1..5A	30V	Straight	PCB version	F1212M-PF/M16

#### Applications

**Industrial Automation:** Suitable for connecting control panels, sensors, and actuators in industrial automation systems.

**Machine Vision Systems:** Used in industrial imaging and inspection systems for signal and data transmission.

**Robotics:** Ideal for use in robotic systems, providing durable connections in environments subject to high vibration and motion.

**Control and Monitoring Systems:** Can be employed in systems that require secure and reliable data and power transmission between components.

This connector is designed to meet high standards of durability, reliability, and performance, making it an essential component for industrial and automation systems requiring secure connections in challenging environments.

#### About Us

Kronz is a manufacturing enterprise located in Zengcheng District, Guangzhou City. We focus on providing customers with high-efficiency industrial automation solutions and related industrial products. After many years of innovation and development, Kronz has complete product processing equipment and a professional team proficient in various automation technologies.

In order to improve the quality of products and production efficiency, we continue to introduce advanced production equipment and technology, strengthen investment in research and development. At present, our main products include Industrial Connectors, Inductive Sensors, Capacitive Sensors, Photoelectric Sensors, Ultrasonic Sensors, Industrial power

supplies, Industrial fieldbus, RFID recognition systems, Industrial Ethernet Switches

We not only produce the orders of standard products, but also have the ability to make customized production based on customer design drawings or samples.

Adhering to the principle of mutual benefit, we provide our customers with competitive prices, and perfect after-sales service. Kronz's products have been sold in multiple countries and have won the trust and praise of customers.

**Kronz expects to cooperation with you.**

### Our Advantage

1. Our team: Kronz is a team with professional R&D capabilities. 2. Our factory: We has the latest production equipment and testing instruments, capable of producing more professional products. 3. Our technical support: Customer service provides 24-hour online service, and communicate with technical personnel at any time to solve technical problems. 4. Our warehouse: We have large capacity warehouse which can provide customers with storage for large quantities of orders. 5. Our location: Our factory is located in Guangzhou, close to Hong Kong, with convenient local transportation, so that export transportation methods are diverse, such as by sea, by air, by railway, and by land.

### Shipping Method

1. Samples and small orders can be shipped with fastshipment method, by air and by express. Bulk order will ship by sea, by air, by train, by truck etc.  
2. We also can send the goods to your agent warehouse.  
3. If you need any more shipping method, please feel free to contact with us.

### FAQ

**Q1: Are you a manufacturer?**

A1: Yes, we are an experienced manufacturer with our research and development, several production line and in-house lab.

**Q2: Do you accept sample order?**

A2: Yes, we do. You can place a sample order with us to test our superior quality and services.

**Q3: Could you produce customized produces?**

A3: Yes, we can produce base on customer provided sample or technical drawings. We also can offer customized logo and package design for mass production.

**Q4: What is your terms of payment?**

A4: T/T payment, 30%-50% deposit, balance before shipment.

**Q5: What is your lead time after payment?**

A5: Normally, 3-5 working days for sample order, 10-15 working days for mass production. If your project involves new molds, lead time is subject to custom product complex.

**Q6: Do you offer guarantee for the products?**

A6: Yes, we offer 2-3 years' warranty.

**Q7: How do you control the quality?**

A7: Quality is priority. We have professional quality inspections in every production process to strictly control the products. A final quality inspection will be conducted on the finished products before packaging. Our factory has gained ISO9001, GJB9001, QPL ISO14001, certificates.

## KRONZ Kronz (guangzhou) Electronics Co., Ltd.



+8618924160375



sales02@kronz.cn



connector-industrial.com

6th Floor, B602 Building, No.10, Rong Jing 2nd Road, Yu Shan Guo Ji, Yong Ning Street, Zeng Cheng District, Guangzhou, P.R.China