



RJ45 Connector with Durability IP20 Class Contact Resistance $\leq 5\text{m}\Omega$

Basic Information

- Place of Origin: Guangdong, China
- Brand Name: KRONZ
- Certification: CE
- Model Number: RJ45S-10/E10K
- Minimum Order Quantity: 80
- Price: Negotiable
- Packaging Details: Polybag packing
- Delivery Time: 5-8 working days
- Payment Terms: T/T, Western Union, MoneyGram
- Supply Ability: 100000 pieces per month



Product Specification

- Pin: 4
- Material Of Grip Body: TPU, black
- Contact Nut Material: Brass, nickel-plated
- Seal Material: FPM/FKM
- Ambient Temperature: $-25\sim+85$
- Insulation Resistance: $\geq 100\text{M}\Omega$
- Voltage: 48V
- Rated Current: 1.5A
- Highlight: IP20 RJ45 Connector, 1.5A RJ45 Connector, Durability RJ45 Connector



Product Description

RJ45 Connector with Durability IP20 Class Contact Resistance $\leq 5\text{m}\Omega$

Product Description

The Connector RJ45 is made with high-quality materials to ensure durability and longevity. The contact carrier material is PA, black, which provides excellent resistance to wear and tear, as well as protection against corrosion. This material is also known for its high heat resistance, which ensures that the connector can operate at high temperatures without degrading or failing.

The Thread type of this connector is RJ45, which is a standard connector used in Ethernet networking. This thread type ensures compatibility with a wide range of networking devices, making it an ideal choice for various applications. The connector is also available in a customized length, which allows you to choose the perfect length for your specific networking needs.

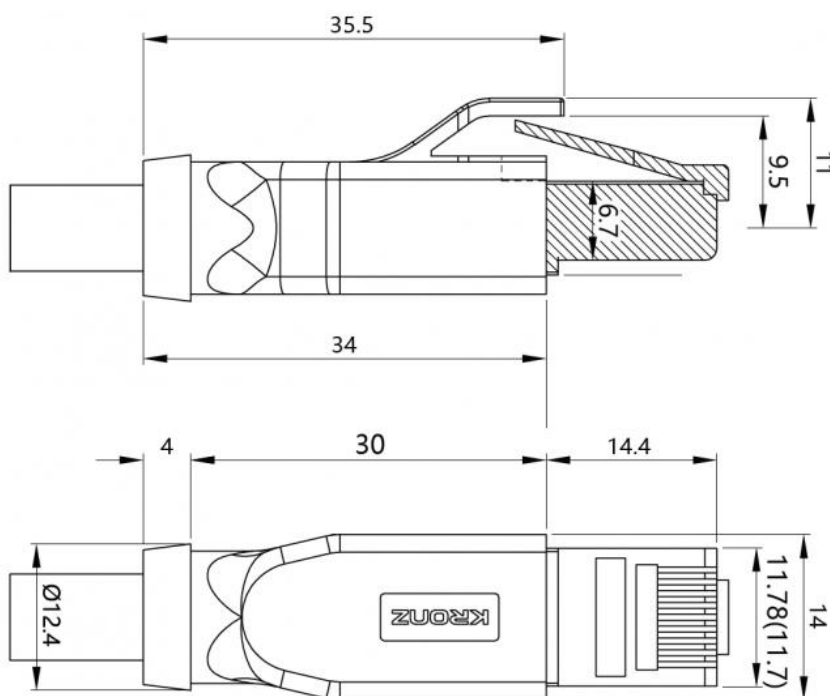

Technical Data

Thread type	RJ45
Contact nut material	Brass, nickle-plated
Contact surface material	Brass, gold-plated
Contact carrier material	PA, black
Housing material	TPU, black
Seal material	FPM/FKM
Insulation resistance	$\geq 100\text{M}\Omega$
Contact resistance	$\leq 5\text{m}\Omega$
Pollution degree	3
Ambient temperature	-25~+85
Mating cycles	>100
Degree of protection	IP20

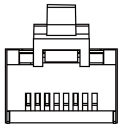
Pin assignment	Wire color	PIN	Rated current	Voltage	Wire gauge	Cable outlet	Length	Model No.
	1 = YE 2 = OR 3 = WH 6 = BU	4PIN	1.5A	48V	2×2×0.25, shielded (2×2×24AWG) Blueish green, PVC, OD=6.5	Straight	10M	RJ45S-10/E10K

Application

The KRONZ RJ45 connector can be used in a variety of product application occasions and scenarios. It can be used in the production of networking equipment, such as network switches, network routers, and network modems. The RJ45 connector can also be used in the production of Ethernet cables. The connector can be used in both commercial and residential

applications, such as in the production of network cables for homes, offices, and data centers.





Support and Services

The RJ45 Connector product technical support and services include:

- Product installation guidance and troubleshooting
- Technical consultation for product selection and compatibility
- Product customization services to meet specific customer needs
- Product performance optimization and testing services
- Warranty and repair services for defective products

FAQ

Q: Where is this product manufactured?

A: This product is manufactured in Guangdong, China.

Q: Does this product have any certifications?

A: Yes, this product is CE certified.

Q: What is the minimum order quantity for this product?

A: The minimum order quantity for this product is 80.

Q: Is the price of this product negotiable?

A: Yes, we will offer different price according to the quantity.

Q: How is this product packaged?

A: This product is packaged in polybag packing, export carton.

Q: What is the delivery time for this product?

A: The delivery time for this product is 5-8 working days for MOQ 80pcs, if more quantity, please contact with seller.

Q: What payment terms are accepted for this product?

A: The payment terms accepted for this product are T/T, Western Union, and MoneyGram.

Q: What is the supply ability of this product?

A: The supply ability of this product is 100000 pieces per month.



+8618924160375



sales02@kronz.cn



connector-industrial.com

6th Floor, B602 Building, No.10, Rong Jing 2nd Road, Yu Shan Guo Ji, Yong Ning Street, Zeng Cheng District,
Guangzhou, P.R.China