



## Linear Beam 30-300mm Sensing Range Photoelectric Sensors IP64 Rating Laser 655nm

### Our Product Introduction

#### Basic Information

- Place of Origin: Guangdong, China
- Brand Name: KRONZ
- Certification: CE
- Model Number: BLQ20S-G300P
- Minimum Order Quantity: 1
- Price: Negotiable
- Packaging Details: Polybag packing
- Delivery Time: 5-8 working days
- Payment Terms: T/T, Western Union, MoneyGram
- Supply Ability: 10000 pieces per month

**KRONZ**

#### Product Specification

- Sensing Range: 30-300mm
- Ip Rating: IP64
- Response Time: <0.5ms
- Distance Deviation: <3%
- Power Supply: DC 12~24V; Ripple :±10%
- Storage Temperature: -40°C+70°C (non-freezing, non-condensing)
- Sensing Method: Linear Beam
- Switching Mode: Light/dark Switching
- Highlight: **655nm Photoelectric Sensors,  
IP64 Photoelectric Sensors,  
30mm Photoelectric Sensors**

**KRONZ**

## Product Description

### Product Description:

The Photoelectric Sensors product is a versatile and reliable solution for various industrial automation applications. Designed as a Threaded mounting type, these sensors offer a secure and stable installation for seamless integration into your systems. With an impressive IP64 rating, the sensors are well-protected against dust and water ingress, ensuring long-lasting performance even in challenging environments.

#### What is CMOS LASER DISPLACEMENT PHOTOELECTRIC SENSOR?

A CMOS laser displacement photoelectric sensor is a **precision tool** used to measure the exact **position, height, or thickness** of an object without touching it. It does this by projecting a laser beam onto the object and using a **CMOS (complementary metal-oxide-semiconductor) sensor** to detect the reflected light.

The key technology inside the sensor — the **CMOS image sensor** — captures the position of the reflected laser spot with **high accuracy and speed**. This data is then used to calculate how far away the object is. The sensor can detect even tiny changes in position, often at the **micron or sub-micron level**.

# KRONZ

## PHOTOELECTRIC SENSOR

### Background suppression

- ◆ For diffuse sensors with background suppression:  
reliable object detection with different ranges,  
virtually independent of surface,  
color and material





NPN	BLQ20-G300N (Pointed beam)
Assure Sensing range Sa	40-300mm (white paper:100mm) 40-280mm (black paper:100mm)
White/black deviation	3%(160mm)
Sensing range Sn	30-300mm
Current consumption	3mA
Wave length	Laser (655nm)
Control output	open collector; NPN/PNP; Switching mode: Light/dark switching
Power supply	DC 12~24V; ripple :±10%
Response time	0.5ms
Ambient temperature	Operating: -25°C~+55°C; Storage: -40°C+70°C (non-freezing,non-condensing)
IP rating	IP64

# Connection Diagram

## DC NPN

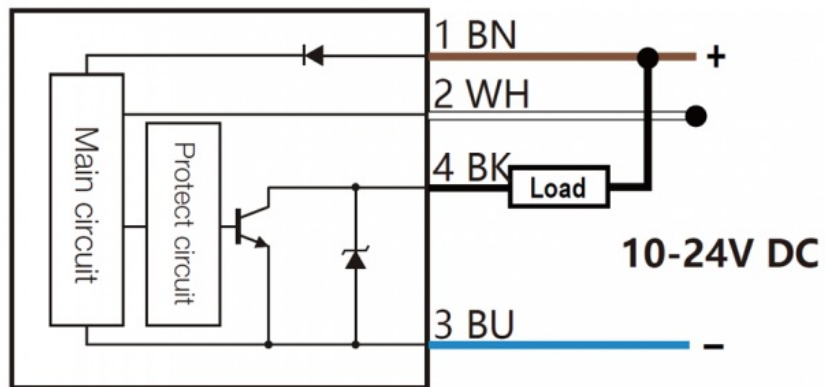

\*LIGHT-ON : WH---NC  
DARK-ON : WH---0V

## DC PNP

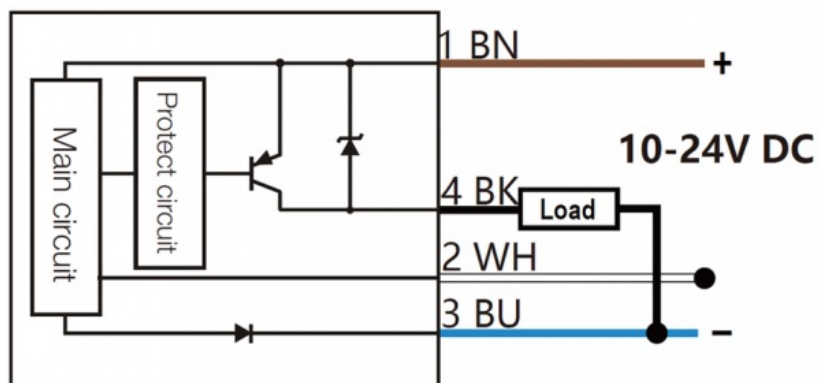

\*LIGHT-ON: WH---NC  
DARK-ON: WH---0V

# Dimensional Drawing

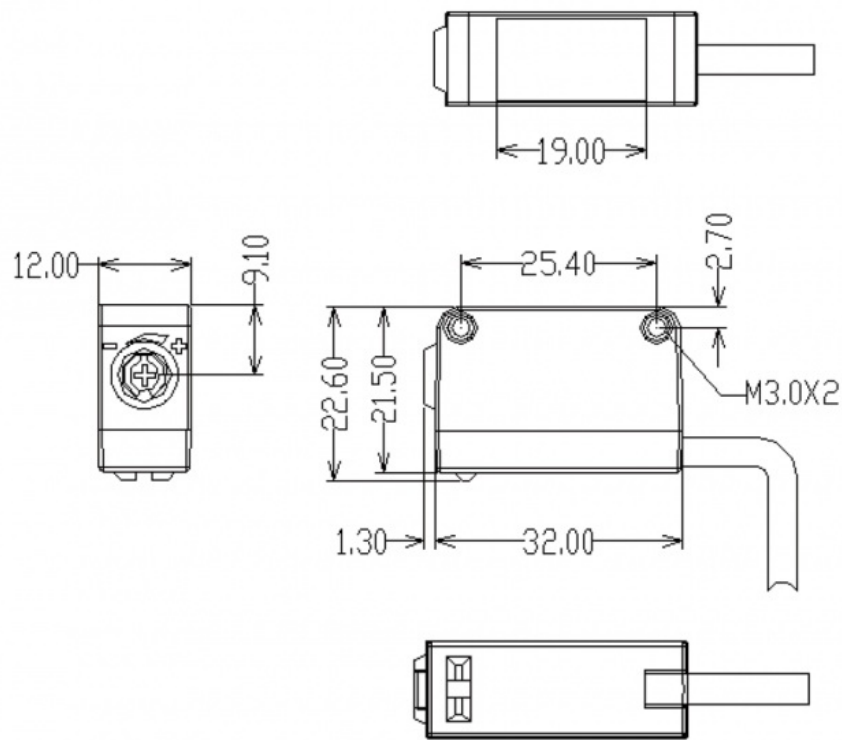

(Dimensions in mm)

## Applications:

KRONZ Photoelectric Sensors are versatile devices that find applications in various industries and scenarios due to their advanced features and reliable performance. These sensors, utilizing the through-beam sensing method, are ideal for detecting opaque objects in a wide range of operating temperatures from -25°C to 55°C.

### CMOS Laser Displacement Photoelectric Sensor for Packaging & Logistics Equipment

Carton or Object Height Detection: Classifies or sorts packages based on their height in conveyor systems.

Labeling and Printing Height Calibration: Ensures printers or label applicators operate at the correct distance from packaging.

# KRONZ

## ABOUT US

KRONZ is a manufacturing enterprise located in Zengcheng District, Guangzhou City. We focus on providing customers with high-efficiency industrial automation solutions and related industrial products. After many years of innovation and development, KRONZ has complete product processing equipment and a professional team who are proficient in various automation technologies.

In order to improve the quality of products and production efficiency, we continue to introduce advanced production equipment and technology, strengthen investment in research and development. At present, our main products include Industrial Connectors, Inductive Sensors, Capacitive Sensors, Photoelectric Sensors, Ultrasonic Sensors, Industrial power supplies, Industrial fieldbus, RFID recognition systems, Industrial Ethernet Switches

We not only produce the orders of standard products, but also have ability to make customize production based on customer design drawings or samples.

Adhering to the principle of mutual benefit, we provide our customers with competitive prices , and perfect after-sales service. Kronz's products have been sold in multiple countries, have won the trust and praise of customers. KRONZ expect to collaborate with you.

## OUR FACTORY





# Certifications

# Logistics and Payment



1. Samples and small orders can be shipped with fast shipment method, by air and by express. Bulk order will ship by sea, by air, by train, by truck etc.

2. We also can send the goods to your agent warehouse.

3. If you need any more shipping method, please feel free to contact with us.







### Note:

Due to the wide range of our products, we cannot list all product pictures and corresponding product parameters. If you have other needs, please communicate with me. We can provide supplementary information and technical support.  
We Are Happy to Serve You.



## **KRONZ** Kronz (guangzhou) Electronics Co., Ltd.



+8618924160375



sales02@kronz.cn



connector-industrial.com

6th Floor, B602 Building, No.10, Rong Jing 2nd Road, Yu Shan Guo Ji, Yong Ning Street, Zeng Cheng District,  
Guangzhou, P.R.China