



## 12-24V DC Photoelectric Sensors Diffuse Reflection 40-300mm Sensing Range For White Paper

### Our Product Introduction

For more products please visit us on [connector-industrial.com](http://connector-industrial.com)

#### Basic Information

- Place of Origin: Guangdong, China
- Brand Name: KRONZ
- Certification: CE
- Model Number: BLQ20-G300P
- Minimum Order Quantity: 1
- Price: Negotiable
- Packaging Details: Polybag packing
- Delivery Time: 5-8 working days
- Payment Terms: T/T, Western Union, MoneyGram
- Supply Ability: 10000 pieces per month

**KRONZ**

#### Product Specification

- Operating Temperature: -25°C To 55°C
- Light Source: Infrared LED
- Housing Material: PBT
- Sensing Distance: 30-300mm
- Response Time: <0.5ms
- Wave Length: Laser (655nm)
- Storage Temperature: -40°C To 70°C
- Residual Voltage: 1V (operating Current: 10mA)
- Highlight: **300mm Sensing Range Photoelectric Sensors, 40mm Photoelectric Sensors**

**KRONZ**

## Product Description

### Product Description:

A Photoelectric Sensor is a type of sensor that detects the presence or absence of an object using a light transmitter and a receiver. One popular variation of this sensor is the Infrared Light Sensor, which utilizes infrared light to sense objects. The Photoelectric Sensors are widely used in industrial automation applications due to their reliability and versatility.

#### What is a photoelectric sensor?

A photoelectric sensor is a type of position-sensing device widely used in industrial automation to detect the presence, absence, or distance of an object using a beam of light. It operates based on the principle of light transmission and reception. The sensor system primarily consists of two main components: an **Emitter**, which produces a beam of light (typically infrared or visible), and a **Receiver**, which detects the presence or absence of this light.

# KRONZ





NPN	BLQ20-G300N (Pointed beam)
Assure Sensing range Sa	40-300mm (white paper:100mm) 40-280mm (black paper:100mm)
White/black deviation	3%(160mm)
Distance deviation	3%
Sensing range Sn	30-300mm
Current consumption	3mA
Wave length	Laser (655nm) JIS/IEC CLASS 1,FDA CLASS I 4.5mW
Control output	open collector; NPN/PNP; Switching mode: Light/dark switching
IP rating	IEC60529: IP64
Housing material	PBT

# Connection Diagram

## DC NPN

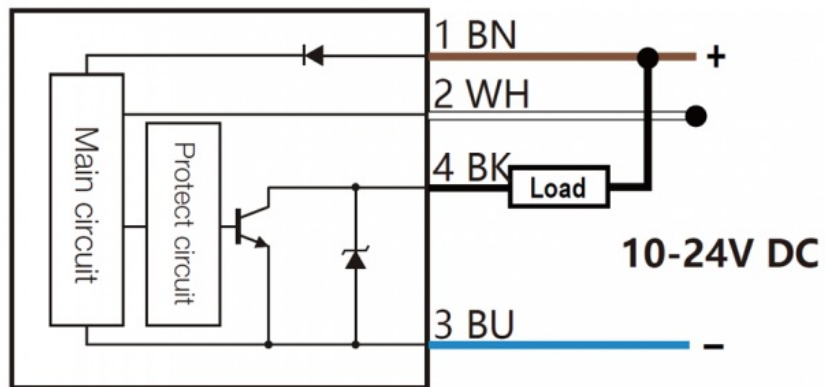

\*LIGHT-ON : WH---NC  
DARK-ON : WH---0V

## DC PNP

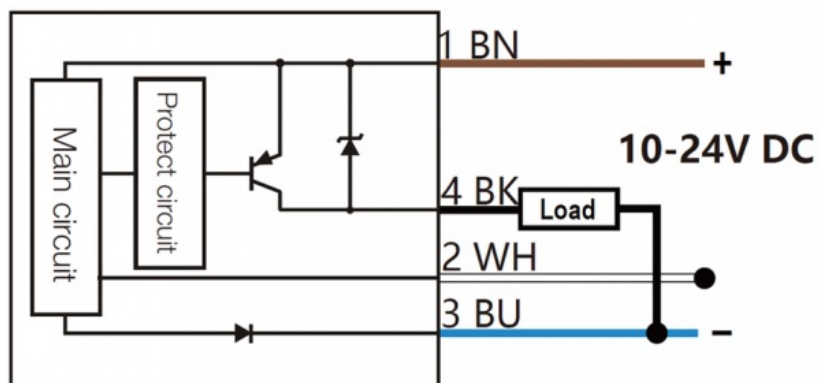

\*LIGHT-ON: WH---NC  
DARK-ON: WH---0V

# Dimensional Drawing

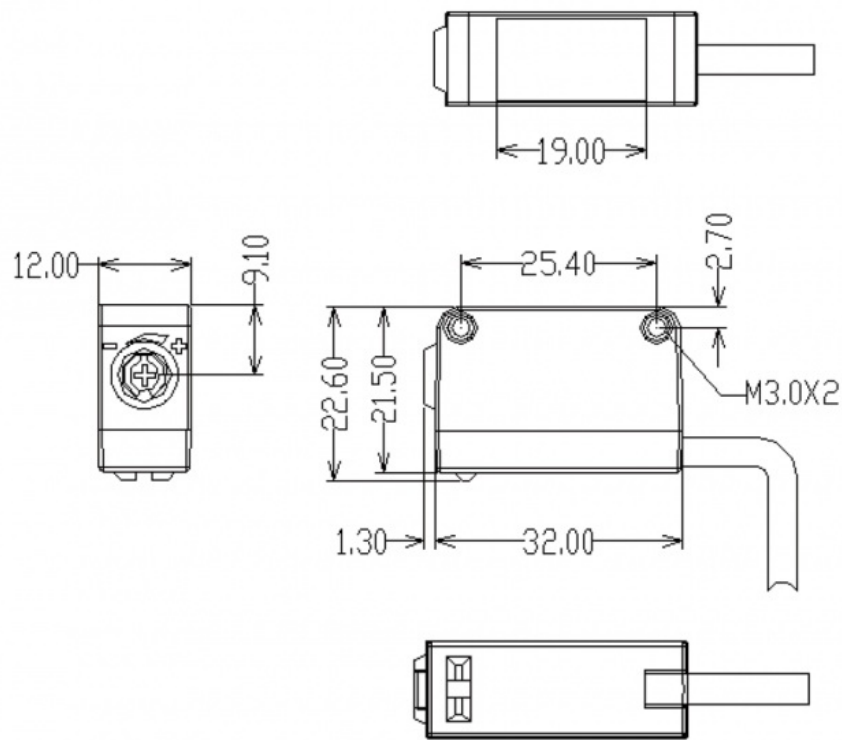

(Dimensions in mm)

## Applications:

KRONZ Photoelectric Sensors are versatile devices that can be used in a wide range of product application occasions and scenarios. . . . These sensors, originating from Guangdong, China, are CE certified and offer a sensing distance of 20-300mm with a response time of 1ms.

### How are photoelectric sensors used in industrial automation?

When the emitted light travels from the Emitter to the Receiver without interruption, the sensor remains in a default state. However, when an object passes through or reflects the light beam, it disrupts or redirects the light path. This change is detected by the Receiver, which converts the variation in received light intensity into an electrical signal. This signal is then used to trigger a response, such as activating a machine, stopping a conveyor belt, or counting parts on a production line.

# KRONZ

## ABOUT US

KRONZ is a manufacturing enterprise located in Zengcheng District, Guangzhou City. We focus on providing customers with high-efficiency industrial automation solutions and related industrial products. After many years of innovation and development, KRONZ has complete product processing equipment and a professional team who are proficient in various automation technologies.

In order to improve the quality of products and production efficiency, we continue to introduce advanced production equipment and technology, strengthen investment in research and development. At present, our main products include Industrial Connectors, Inductive Sensors, Capacitive Sensors, Photoelectric Sensors, Ultrasonic Sensors, Industrial power supplies, Industrial fieldbus, RFID recognition systems, Industrial Ethernet Switches

We not only produce the orders of standard products, but also have ability to make customize production based on customer design drawings or samples.

Adhering to the principle of mutual benefit, we provide our customers with competitive prices , and perfect after-sales service. Kronz's products have been sold in multiple countries, have won the trust and praise of customers. KRONZ expect to collaborate with you.

## OUR FACTORY



## Certifications





# Logistics and Payment



1. Samples and small orders can be shipped with fast shipment method, by air and by express. Bulk order will ship by sea, by air, by train, by truck etc.
2. We also can send the goods to your agent warehouse.
3. If you need any more shipping method, please feel free to contact with us.



## Note:

Due to the wide range of our products, we cannot list all product pictures and corresponding product parameters. If you have other needs, please communicate with me. We can provide supplementary information and technical support. We Are Happy to Serve You.



CONTACT US

**KRONZ** Kronz (guangzhou) Electronics Co., Ltd.



+8618924160375



sales02@kronz.cn



connector-industrial.com

6th Floor, B602 Building, No.10, Rong Jing 2nd Road, Yu Shan Guo Ji, Yong Ning Street, Zeng Cheng District,

