



## Slot-Type Photoelectric Sensor NPN BSM-K25N Power Supply 5~24VDC±10%

### Our Product Introduction

#### Basic Information

- Place of Origin: Guangdong China
- Brand Name: KRONZ
- Certification: CE
- Model Number: BSM-K25N
- Minimum Order Quantity: 1
- Price: Negotiable
- Packaging Details: Polybag packing
- Delivery Time: 5-8 working days
- Payment Terms: T/T, Western Union, MoneyGram
- Supply Ability: 10000 pieces per month

KRONZ



#### Product Specification

KRONZ



## Product Description

The **BSM-K25N** is a high-precision slot-type photoelectric sensor designed for reliable object detection in compact spaces. With a built-in emitter and receiver arranged in a U-shaped housing, it allows for easy installation and no need for alignment. The sensor operates with a **wide power supply range of 5~24V DC  $\pm 10\%$** , making it highly adaptable to various industrial control systems, including low-voltage logic circuits.

This model features an **NPN open collector output**, ideal for use with PLCs and digital input devices that require sinking input signals. The BSM-K25N delivers fast response and stable performance, even in environments with variable ambient lighting.

### Features:

**Slot-Type Through-Beam Design:** Built-in emitter and receiver in one compact body.

**Wide Power Supply Range:** 5 to 24V DC  $\pm 10\%$ , suitable for both logic-level and industrial systems.

**NPN Open Collector Output:** Compatible with standard sinking input control circuits.

**Fast Response Time:** Ensures high-speed and accurate object detection.

**Compact & Lightweight:** Ideal for installation in tight or moving machine parts.

**Ambient Light Immunity:** Reliable performance in challenging lighting conditions.

**LED Indicator:** Visual status indication for easy setup and troubleshooting.

**Reverse Polarity Protection:** Enhances durability and circuit protection.

### Technical Parameters

Detection Distance	5mm(Fixed)
Detected Object	1.2 x 0.8mm Opaque Detection Object
Repeatability	< 0.01mm
Power Supply	5~24VDC $\pm 10\%$
Control Output	Switching Capacity: 100mA, Residual Voltage <1V
Indicator	Red LED (Illuminates when light is received)
Output Operation	Equipped with dual outputs (ON when light is blocked, ON when light is received)
Protection Circuit	Reverse Polarity Protection, Overcurrent Protection, Short-Circuit Protection
Ambient Temperature	Operating: -25~70° C (Condensation-Free, Ice-resistant) Storage: -30~80° C
Ambient Humidity	Operating: 5~95%RH; Storage: 5~85%RH
Temperature Effect	Operating Temperature Range: -25° C to +70° C, with $\leq \pm 10\%$ variation in sensing distance per 20° C change
Voltage Effect	Within $\pm 15\%$ fluctuation of the rated power supply voltage, the sensing distance variation shall be $\leq \pm 1\%$ .
Withstand Voltage	AC1000V 1min between all power terminals and enclosure
Insulation Resistance	Insulation resistance $\geq 20M\Omega$ between all power terminals and enclosure, measured with 250V megohmmeter.
Vibration Resistance	Frequency: 10Hz~2,000Hz, Double Amplitude: 1.5mm (Peak Acceleration: 196m/s <sup>2</sup> ), 2 hours per axis (X/Y/Z)
Shock Resistance	Acceleration: 15,000 m/s <sup>2</sup> (approx. 1,500 G), 3 times in each XYZ direction
Connection Method	Standard lead wire type (2m PVC cable) or customizable PUR drag chain cable
Material	Housing: PBT, Lens Cover: Polycarbonate (PC)
Protection Level	IP67
Wire Diameter	2.5mm

### Product Images

# KRONZ



# KRONZ



# KRONZ



**Product Dimension Drawing**

# BSM-K25

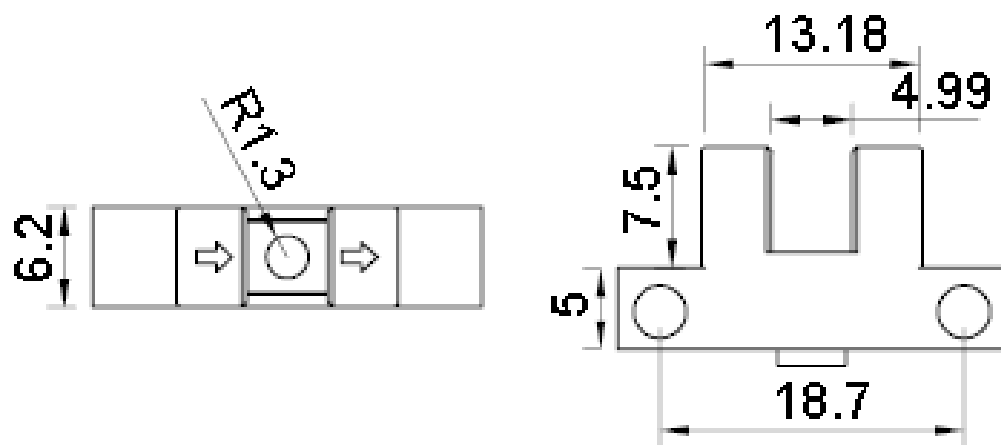

Company Profile

# KRONZ

## ABOUT US

KRONZ is a manufacturing enterprise located in Zengcheng District, Guangzhou City. We focus on providing customers with high-efficiency industrial automation solutions and related industrial products. After many years of innovation and development, KRONZ has complete product processing equipment and a professional team who are proficient in various automation technologies.

In order to improve the quality of products and production efficiency, we continue to introduce advanced production equipment and technology, strengthen investment in research and development. At present, our main products include Industrial Connectors, Inductive Sensors, Capacitive Sensors, Photoelectric Sensors, Ultrasonic Sensors, Industrial power supplies, Industrial fieldbus, RFID recognition systems, Industrial Ethernet Switches

We not only produce the orders of standard products, but also have ability to make customize production based on customer design drawings or samples.

Adhering to the principle of mutual benefit, we provide our customers with competitive prices , and perfect after-sales service. Kronz's products have been sold in multiple countries, have won the trust and praise of customers. KRONZ expect to collaborate with you.

## OUR FACTORY





# Certifications





# Logistics and Payment



1. Samples and small orders can be shipped with fast shipment method, by air and by express. Bulk order will ship by sea, by air, by train, by truck etc.
2. We also can send the goods to your agent warehouse.
3. If you need any more shipping method, please feel free to contact with us.





### Note:

Due to the wide range of our products, we cannot list all product pictures and corresponding product parameters. If you have other needs, please communicate with me. We can provide supplementary information and technical support.  
We Are Happy to Serve You.



## **KRONZ** Kronz (guangzhou) Electronics Co., Ltd.



+8618924160375



sales02@kronz.cn



connector-industrial.com

6th Floor, B602 Building, No.10, Rong Jing 2nd Road, Yu Shan Guo Ji, Yong Ning Street, Zeng Cheng District,  
Guangzhou, P.R.China